



ZODIAC



MARSTM HP

**AUTOMATIC INGROUND
PRESSURE-SIDE POOL CLEANER**

Instruction Manual & Warranty Card

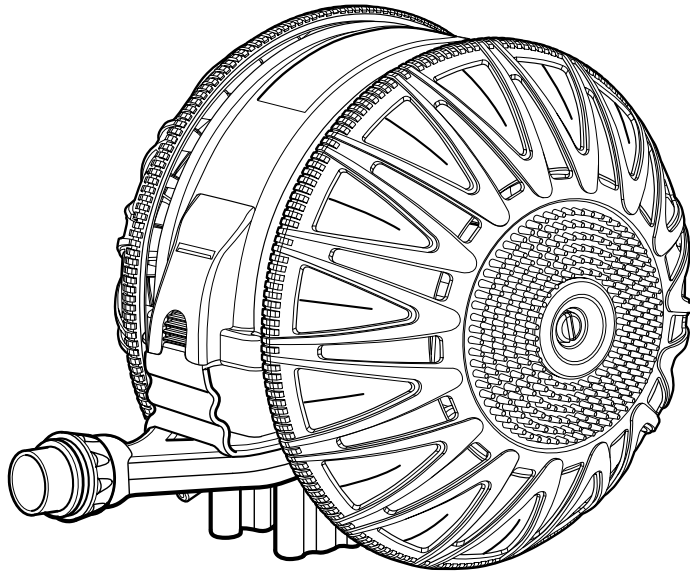

Mars HP operates differently than other pressure-side pool cleaners.
Please read the entire manual to ensure optimum performance.

BARACUDA[®]

It's a pool cleaner not a fish

Zodiac, *Mastering the Elements*

Renowned worldwide for the quality and reliability of its products in the aeronautical and marine sectors, Zodiac has now brought its expertise to swimming pools, to bring you a full range of pools, automatic pool cleaners and water treatment systems.

Backed by Baracuda technology, expertise and experience, Zodiac brings you the reassurance of top quality equipment in terms of both design and performance.

A real guarantee of efficiency and peace of mind!

Dear Customer,

Thank you for purchasing the world's simplest automatic swimming pool cleaner. The Zodiac MARS HP™ has been designed and manufactured to be easily installed and to provide years of low maintenance operation.

No automatic pool cleaner equals your new Zodiac MARS™ HP for performance, efficiency and reliability. Because of its simple New Age Technology and unique design, your Zodiac MARS™ HP is virtually maintenance free.

- Your Zodiac MARS™ HP has no moving parts to jam, wear or come adrift. No nuts, bolts, screws, gears or wheels to corrode.
- Its innovative cassette diaphragm system sucks up dirt, debris, bugs, leaves and even pebbles.
- Your Zodiac MARS™ HP will quickly and quietly clean an average pool wall-to-wall, top-to-bottom (excluding steps and swimouts).
- In the event of requiring repairs, please take your Zodiac MARS™ HP to your closest pool shop.
- REMEMBER TO REGISTER YOUR WARRANTY WITHIN FOURTEEN (14) DAYS FROM DATE OF PURCHASE.

IT'S EASY TO INSTALL. JUST READ THE INSTRUCTIONS IN THE MANUAL CAREFULLY.

THE CONTENTS OF YOUR ZODIAC MARS™ HP BOX ARE AS FOLLOWS:

- One complete Zodiac MARS™ HP unit
- Mars Supply Hose
- One Warranty Card
- One Instruction Manual

BARACUDA® is a Registered Trade Mark.

Specifications and equipment are subject to change without prior notice.

INDEX

	Page
SECTION 1 – PREPARING YOUR POOL AND FILTRATION SYSTEM	1
SECTION 2 – SUPPLY HOSE ADJUSTMENT AND INSTALLATION.....	2
SECTION 3 – OPERATION	7
SECTION 4 – DEBRIS TRAP.....	10
SECTION 5 – CARE AND MAINTENANCE	12
SECTION 6 – TROUBLESHOOTING.....	17
SECTION 7 – MARS™ HP PARTS DIAGRAM.....	18
SECTION 8 – MARS™ HP HOSE PARTS DIAGRAM.....	19
SECTION 9 – LET US HELP!.....	20
WARRANTY INFORMATION	21

PRODUCT INTRODUCTION

Welcome to Zodiac MARS™ HP, the simplest, most innovative pressure-side pool cleaner. Its simple design will provide superior pool cleaning and years of carefree maintenance.

Zodiac MARS™ HP operates differently than other pressure-side pool cleaners. Please read the entire manual to ensure optimum performance.

If you had a different brand pressure-side cleaner, you may have purchased the Zodiac MARS™ HP as a head and hose assembly only. You may use your existing booster pump, but to ensure optimum performance, do not use your existing hose. Follow the instructions using the Zodiac Mars™ HP supply hose that came with your Zodiac MARS™ HP pool cleaner.

POOL PREPARATION

Your swimming pool will require basic preparation before installing your Zodiac MARS™ HP pool cleaner. Please do the following:

- Empty the skimmer basket and hair & lint basket.
- Clean the pool filter according to the manufacturer's instructions.
- Manually remove large debris or children's toys.
- Properly install the booster pump.
- Turn off your pool filtration pump and booster pump.

SECTION 2 – SUPPLY HOSE INSTALLATION AND ADJUSTMENT

SUPPLY HOSE INSTALLATION AND ADJUSTMENT

The Zodiac MARS™ HP supply hose consists of 6m of white hose and 3m of clear hose with floats which are attached together with swivels and secured by mender nuts.

Important: Before adjusting the length of the supply hose, remove the complete supply hose from the box and lay it in a straight line in the sun, to relax any coiling that may have occurred during shipping.

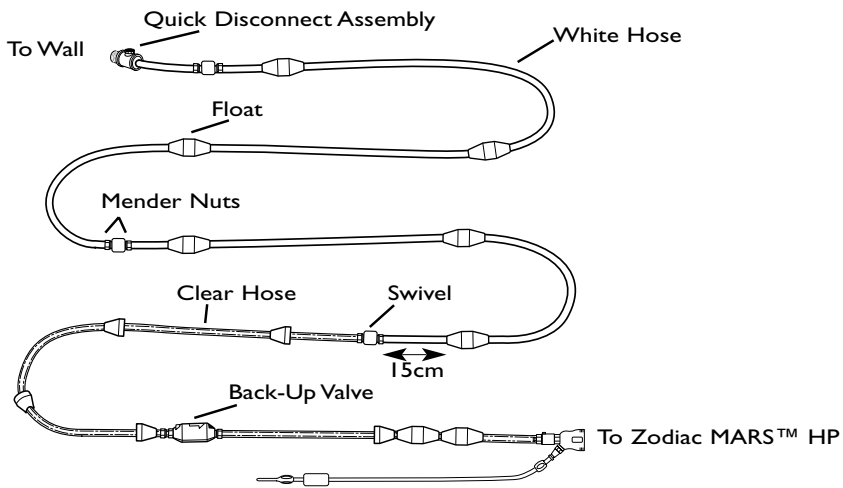

STEP 1: QUICK DISCONNECT ASSEMBLY INSTALLATION

The white section of the Zodiac MARS™ HP supply hose has a quick disconnect with a universal wall fitting, an in-line screen and a pressure relief valve.

NOTE: The in-line screen filters out fine debris. This screen will need to be cleaned periodically. The pressure relief valve is used to adjust the wheel RPM as explained later in the manual.

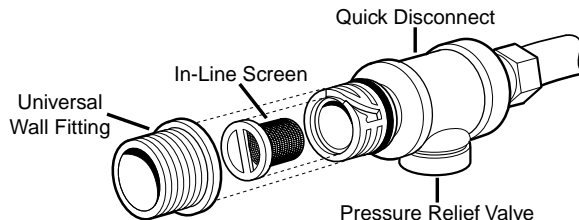

SECTION 2 – SUPPLY HOSE INSTALLATION AND ADJUSTMENT

- Thread the universal wall fitting into the dedicated cleaner line.
- Lock the quick disconnect into the universal wall fitting.

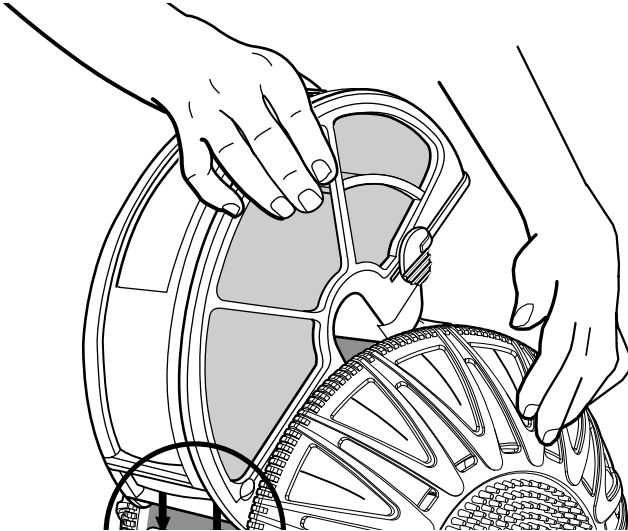

STEP 2: TOTAL SUPPLY HOSE MEASUREMENT

The proper length of the Zodiac MARS™ HP supply hose is critical for optimum performance. Read this section carefully before making adjustments.

- First, measure the distance from the dedicated cleaner line to the farthest point in the pool.
- Add 1 additional metre. This distance will be the total supply hose length, (clear hose & white hose) required for your pool.

NOTE: If this distance is between 8m and 9m use the complete supply hose, no adjustment is required, move to step 4.

If this distance is longer than 9m contact your local Zodiac dealer for additional supply hose.

If this distance is shorter than 8m, you will need to adjust the supply hose length.

SECTION 2 – SUPPLY HOSE INSTALLATION AND ADJUSTMENT

STEP 3: ADJUSTING THE SUPPLY HOSE LENGTH

- Measure the clear hose, so that its length is 0.6m longer than the depth of your pool. If your pool is 2.5m deep or greater, do not shorten the clear hose. (Read on as the white hose may need to be adjusted.)
- Remove the clear hose from the swivel that connects it to the white hose.

NOTE: To remove ANY hose section from a swivel, loosen the mender nut and pull the hose off of the swivel.

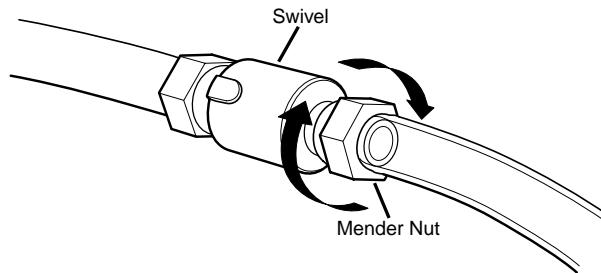

- Cut the pre-measured clear hose from the end you removed from the swivel.
- Re-attach the clear hose to the swivel.

NOTE: To attach ANY hose section to a swivel, slide the mender nut onto the swivel, with the smooth collar facing the swivel, then push the hose onto the barbed end of the swivel and tighten the mender nut. This procedure will be easier if the hose is wet.

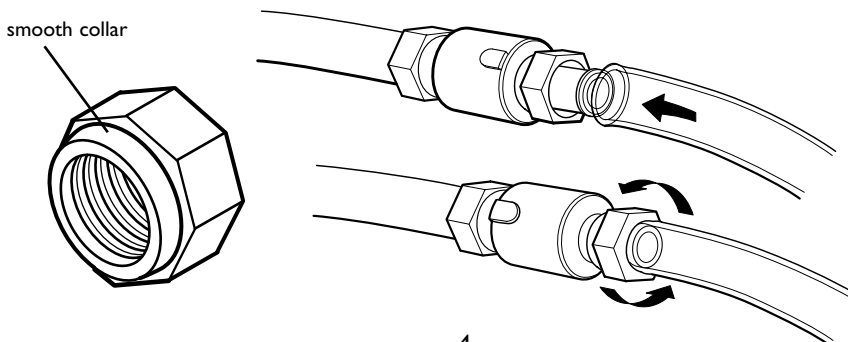

SECTION 2 – SUPPLY HOSE INSTALLATION AND ADJUSTMENT

- Subtract the length of the clear hose from the total supply hose length. This measurement will be the required length of the white hose.

Example:

- 1 The pool is a 4.5x9m rectangle, 2m deep.
 - 2 The measured distance from the dedicated cleaner line to the farthest point of the pool is 7m.
 - 3 After adding 1 additional metre, the total supply hose length is 8m. The clear hose is cut so that it measures 2.5m (0.5m longer than the depth of the pool).
 - 4 After subtracting the 2.5m of clear hose from the total supply hose length of 8m, the white hose will be measured and cut to 5.5m (8m of total supply hose). (This is an example only - your pool may vary.)
- Remove the white hose from the swivel that connects it to the clear hose.

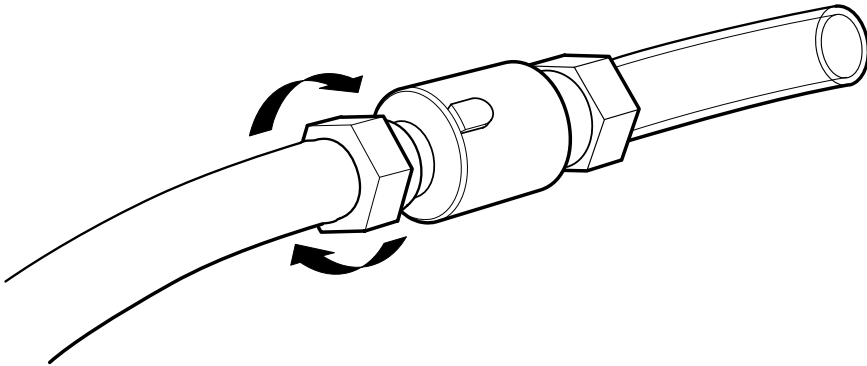

- Measure and cut the end of the white hose you removed from the swivel, as instructed for your size pool. You may be removing hose floats.

SECTION 2 – SUPPLY HOSE INSTALLATION AND ADJUSTMENT

Important: There must always be a hose float on the white hose, within 15cm from the swivel, which connects the white hose to the clear hose. Do not reposition the remaining hose floats. You may need to replace one of the hose floats that were removed during adjustment to ensure that a float is within 15cm from this swivel.

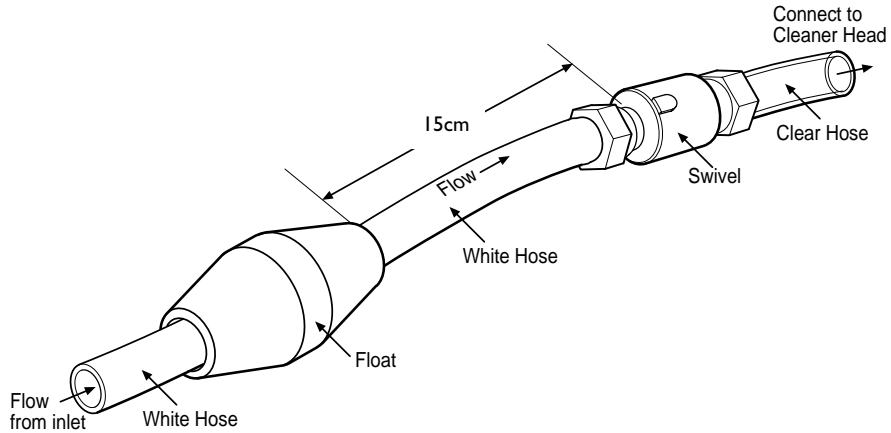

- Re-attach the white hose to the swivel, securing it with a mender nut.

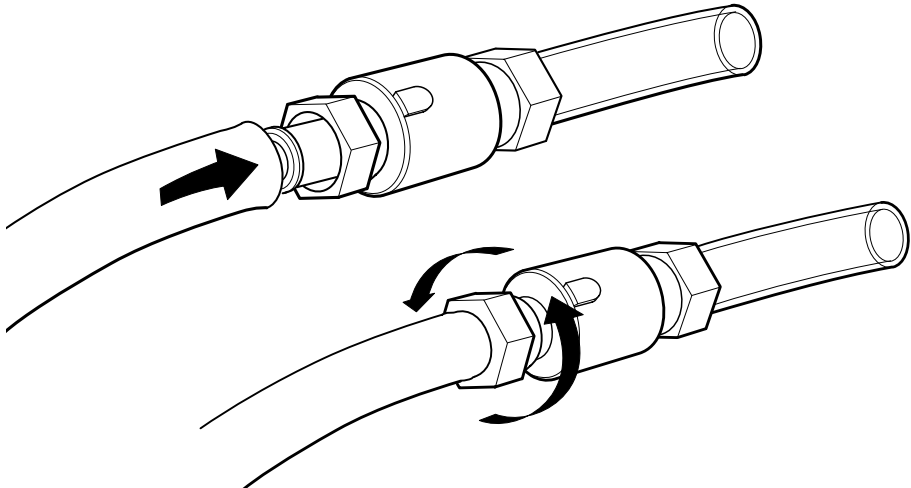

STEP 4: INSTALLING THE MARS CLEANER

- Attach the Zodiac MARS™ HP head to the clear hose end. Take the female end of the handle, which is attached to the clear hose, and slide it over the male end of the handle, which is attached to the cleaner head. Handle will snap into place.

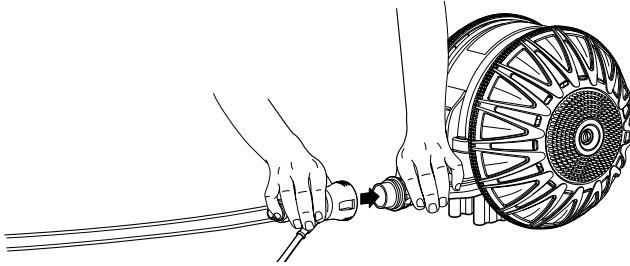

- To remove the cleaner head from the hose, unscrew the male end of the inlet handle and pull.

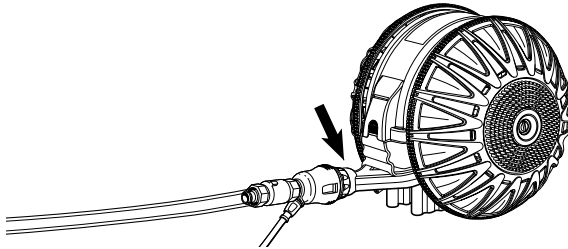

- Confirm that the yellow RPM sticker is in the centre of one of the Zodiac MARS™ HP wheels. If not, apply one of the yellow RPM sticker at this time. Submerge the Zodiac MARS™ HP cleaner in the swimming pool until the air bubbles stop. (The quick disconnect should still be connected to the wall.) Allow the Zodiac MARS™ HP cleaner to sink.

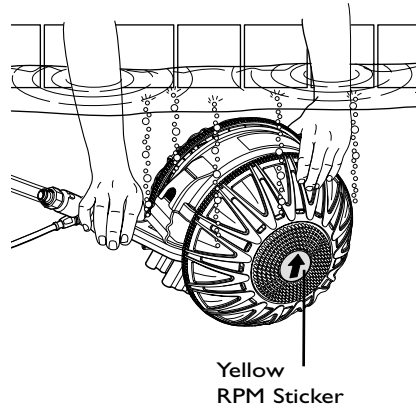

SECTION 3 – OPERATION

Turn on the pool filtration pump and wait 30 seconds before turning on the booster pump. If your Zodiac MARS™ HP pool cleaner is set to run on a timer, be sure that the booster pump turns on after and shuts off before, the filtration pump.

Your Zodiac MARS™ HP pool cleaner will randomly clean an average swimming pool in 3 hours or less. A back-up jet, which cycles on and off for approximately 45 seconds every 3.5 minutes, will pull the Zodiac MARS™ HP cleaner into a different position to improve coverage.

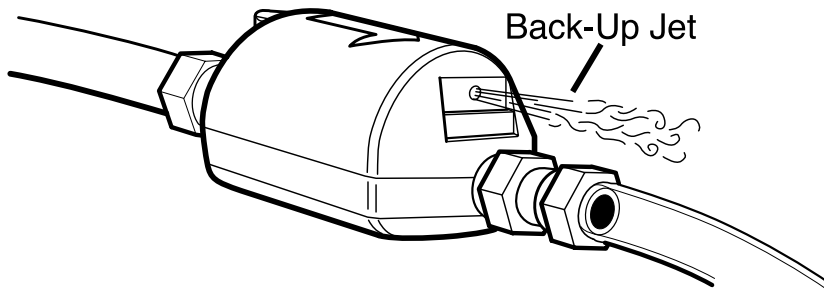

To determine if your Zodiac MARS™ HP pool cleaner is operating at the correct speed; you must count the wheel revolutions or wheel RPM (Revolutions Per Minute).

WHEEL RPM ADJUSTMENT

- Hold the Zodiac MARS™ HP head sideways, just below the surface so as not to be sprayed by water.
- **After the back-up jet has completed one cycle**, use the arrow on the yellow RPM stickers for easier RPM counting and begin timing the wheel revolutions for 1 minute.

The ideal wheel RPM is between 40 and 45. If your wheel RPM is between 40 and 45, remove the sticker and allow the Zodiac MARS™ HP cleaner to clean your pool. Your installation is now complete.

We have included additional RPM stickers for future use. Keep them along with your Zodiac MARS™ HP owner's manual.

SECTION 3 – OPERATION

If your wheel RPM is below 40, please do the following:

- Clean the in-line screen at the universal wall fitting/quick disconnect.
- Check the entire supply hose for leaks.
- If applicable, confirm that the gate valve on the dedicated cleaner line is fully open. Contact your dealer if needed.
- Clean the pool filter, skimmer basket and pump basket.
- Repeat the wheel RPM test.
- If your wheel RPM is now between 40 and 45, remove the yellow RPM count decal and allow the Zodiac MARS™ HP cleaner to clean your pool. Your installation is now complete.
- In the event that your wheel RPM continues to read below 40 contact your Zodiac dealer for further assistance.

If your wheel RPM is above 45:

- Turn off the booster pump.
- Open the pressure relief valve on the quick disconnect.
- Unscrew the pressure relief valve 1/2 turns (pliers may be needed to open the pressure relief valve).
- Retest the wheel RPM
- Open the pressure relief valve as needed to lower the wheel RPM to 45.
- Once your wheel RPM is between 40 and 45, remove the yellow RPM sticker and allow the Zodiac MARS™ HP cleaner to clean your pool. Your installation is now complete.

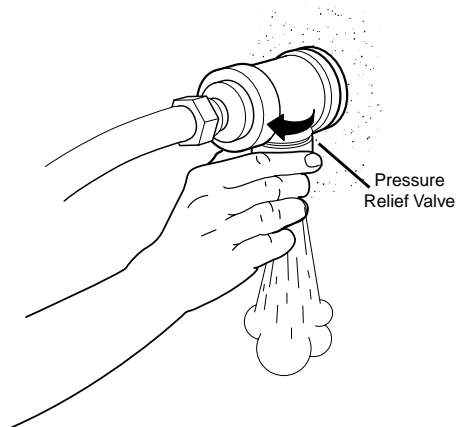

SECTION 4 – DEBRIS TRAP

TO EMPTY THE DEBRIS TRAP

- Turn off the booster pump and remove the Zodiac MARS™ HP head from the swimming pool.
- Press the purple button located just above the handle while lifting the debris trap away from the Zodiac MARS™ HP head.

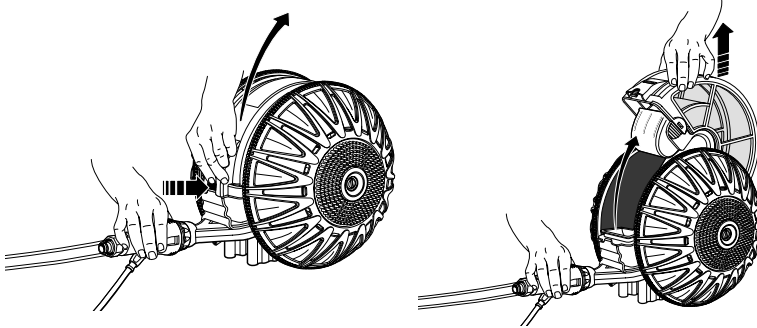

- Pinch the 2 clips on either side of the debris trap to open it.

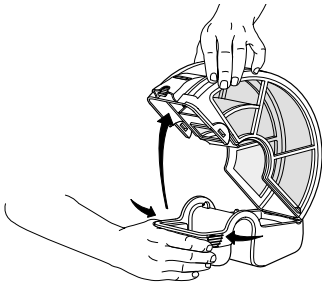

- Empty and gently rinse both halves of the debris trap.

IMPORTANT: Sharp objects or high-pressure water can puncture or tear the mesh panels. Use caution when emptying and rinsing.

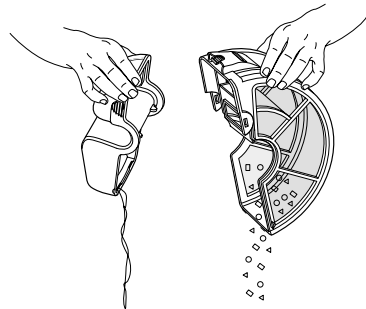

SECTION 4 – DEBRIS TRAP

- Seat the hinge tabs of the top of the debris trap before snapping the clips shut.

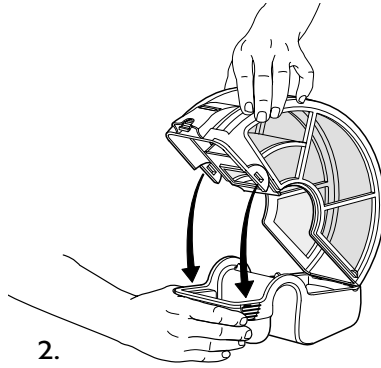
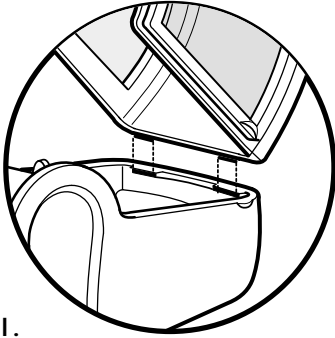

- Seat the base of the debris trap before allowing the purple button to lock into place.

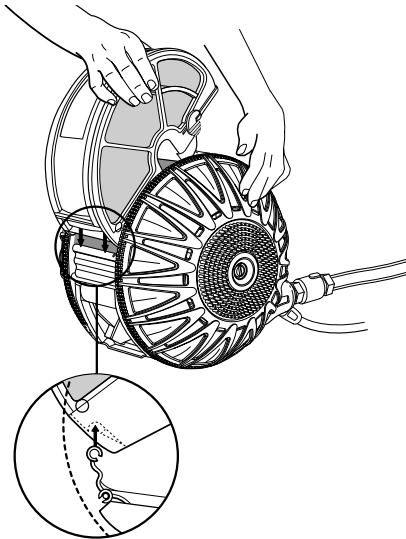

- Be sure that the debris trap is secure.

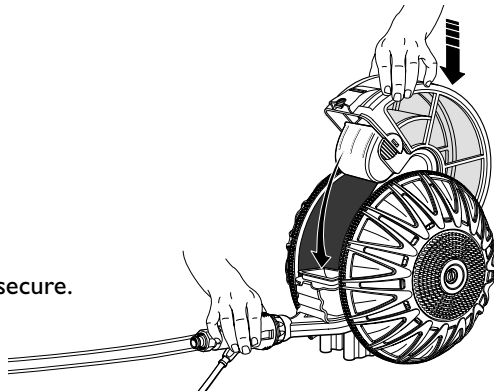

SECTION 5 – CARE & MAINTENANCE

Your Zodiac MARS™ HP pool cleaner has been designed and manufactured to provide years of carefree maintenance. Please follow the guidelines below to help ensure optimum performance.

- Your Zodiac MARS™ HP pool cleaner is not a toy. Do not allow children to play with the Zodiac MARS™ HP pool cleaner. **Remove the Zodiac MARS™ HP pool cleaner from the pool before swimming.**
- When Zodiac MARS™ HP is out of the pool, **do not coil the supply hose.** Coiling will result in poor coverage due to supply hose memory.
- Do not lay objects on top of the Zodiac MARS™ HP unit. During off season storage, ensure unit is stored in flat area without applying pressure to the wheels.
- Store the Zodiac MARS™ HP head on its side when not in use, to avoid possible distortion of the wheels.
- Never run the booster pump if the filtration pump is not running. This may cause booster pump damage that will not be covered under warranty.
- Regularly clean the in-line screen at the universal wall fitting/quick disconnect, see page 3. This screen prevents fine debris from clogging water jets in the Zodiac MARS™ HP head. **Never run your Zodiac MARS™ HP pool cleaner without the in-line screen in place.**
- In freezing conditions, drain your Zodiac MARS™ HP pool cleaner and supply hose and remove them from the pool. Remove the drain plug from the booster pump and drain all of the water out of the pump.
- Always remove the Zodiac MARS™ HP pool cleaner when chemically balancing or super-chlorinating the pool. Replace the Zodiac MARS™ HP pool cleaner after the water is properly balanced or after 4 hours from super-chlorinating the pool.
- Periodically inspect the tyres, wheel bushings, axle bushings and wear strip for wear, replace as needed. Follow the instructions to disassemble and replace these parts. See the parts diagram for identification.

SWEEP REMOVAL

Your Zodiac MARS™ HP cleaner comes preassembled with a power sweep attached to the female end of the inlet handle, at the end of the clear hose section. To remove the sweep, please follow the steps below:

- Turn off the booster pump and remove the Zodiac MARS™ HP head from the pool.
- Unscrew the mender nut that connects the sweep to the female end of the inlet handle.
- Remove the sweep. As the sweep is disconnected from the inlet handle, a valve will close sealing the inlet handle.

SCRUBBER INSPECTION AND REPLACEMENT

- Turn off the booster pump and remove the Zodiac MARS™ HP head from the pool.
- Remove the sweep from the hose assembly using the method described above.
- Inspect the scrubber by turning it over looking for wear points.
- Slowly pull the scrubber toward the end of the sweep, away from the connection point, and remove.

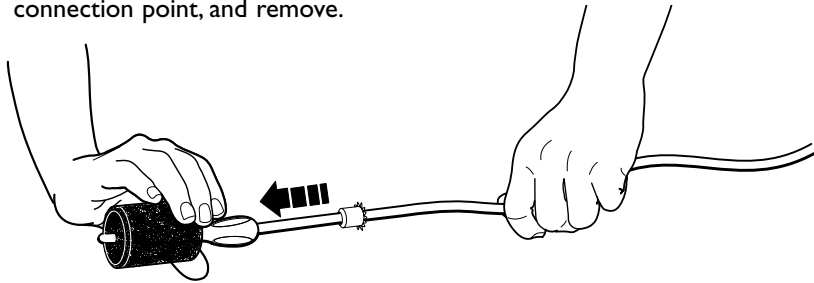

- Install replacement scrubber by pushing it into place over the end of the sweep. The scrubber should be positioned so that the foam retainer is located near the centre on the scrubber. This will hold the scrubber in place. Use the replacement scrubber included with your Zodiac MARS™ HP, or call your local Zodiac dealer.

WEAR STRIP INSPECTION AND REPLACEMENT

- Turn off the booster pump and remove the Zodiac MARS™ HP head from the pool.
- For easier inspection, remove the debris trap.
- Turn the Zodiac MARS™ HP head upside down and inspect the wear strip on the debris door. The wear strip should be replaced when any part of the leading edge of the wear strip has worn down to the hard plastic of the debris door.
- To remove the wear strip, press the bottom trailing edge of the wear strip gently upwards. This will distort the wear strip sufficiently to allow it to be pulled off the locating tabs on the top face of the wear strip. Then, the wear strip can simply be pulled off the debris door.
- To fit a new wear strip, simply position the wear strip in line with the locating clips and push into place. Ensure that the clips are correctly located in the wear strip cut outs provided.

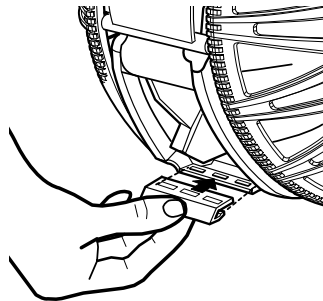
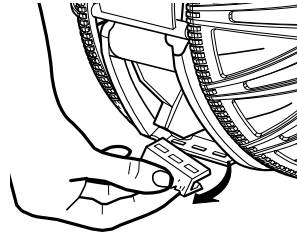
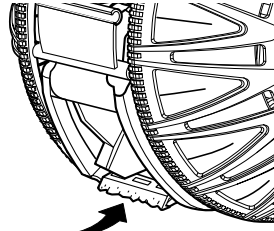

TYRE INSPECTION AND REPLACEMENT

- For easier inspection remove the debris trap.
- Inspect the tread on the edge of the tyres for wear. When the tread of the tyre has worn smooth, replace the tyre.

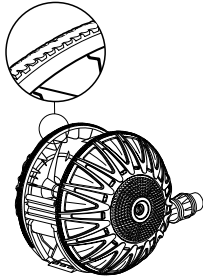

- To replace the tyre, simply peel the old tyre off of the wheel.
- Centre the new tyre onto the wheel and gently stretch the tyre onto the wheel. Ensure that the edge of the new tyre is properly seated along the inner groove of the wheel.

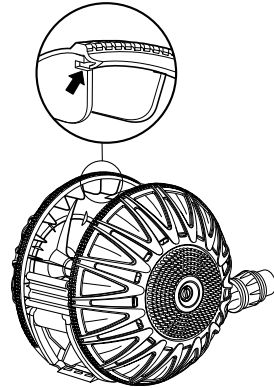

WHEEL & AXLE BUSHING INSPECTION AND REPLACEMENT

- For easier inspection, remove the debris trap.
- Use a screwdriver or coin to loosen one nut, remove the nut.
- Lift the wheel off the axle. Use care not to lose the washer. **NOTE:** The wheel bushing **MAY** remain on the axle when removing the wheel.

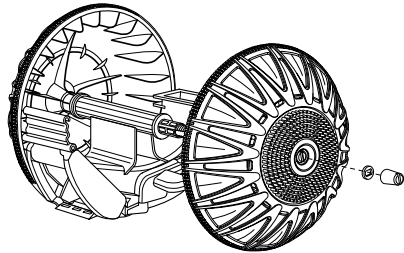

SECTION 5 – CARE & MAINTENANCE

- Remove the other wheel with the axle attached.
- Inspect the wheel bushings and axle bushings for grit or wear.
- Rinse the wheel bushings and axle bushings to remove any sand or grit.

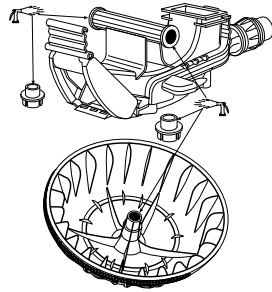

- **IMPORTANT:** Be sure that the wheel bushing is properly seated on the wheel as shown right.

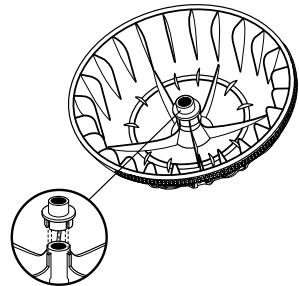

- Slide the axle with the wheel attached, through the axle housing.

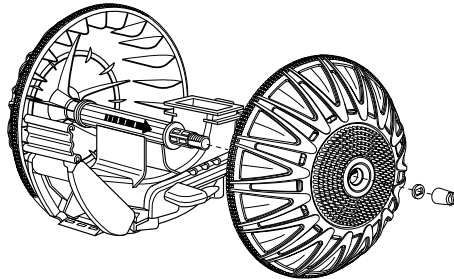

- With the wheel bushing in position, push the other wheel onto the axle.
- Replace the washer and nut. Tighten until snug. Do not over-tighten.
- Re-assemble and spin the wheels. If binding continues to occur, replace the wheel and axle bushings.
- Replace the debris trap.

SECTION 6 – TROUBLESHOOTING

Most problems with your Zodiac MARS™ HP pool cleaner are easily remedied by simple adjustments. Follow the suggested solutions in the order shown below. If the problem continues after trying the suggestions below, please call our technical service on 1800 688 552.

PROBLEM	SOLUTION
Zodiac MARS™ HP sticks in corners or in-pool obstacles for longer than 4 minutes.	<ul style="list-style-type: none">• Confirm wheel RPM is between 40 and 45. See page 10.• Check to see that the backup valve is working properly. If not contact your Zodiac dealer.• Check that the wheels spin freely. Turn off the booster pump and spin the wheels. If binding or vibration is noticed, remove the wheels and rinse the wheel and axle bushings.
Zodiac MARS™ HP is missing large areas of the pool.	<ul style="list-style-type: none">• Confirm wheel RPM is between 40 and 45, see page 10.• Clean the in-line screen at the universal wall fitting/quick disconnect. See page 3.• Check the supply hose for coiling. See page 3.• Confirm that the supply hose length is correct for your pool. See page 4.• Move the hose float on the white hose that is located nearest the clear hose, back 60cm from the swivel.• Empty the debris trap. See page 11.• Confirm that the back-up jet is operating.• Check that the wheels spin freely. If not see page 15.
Zodiac MARS™ HP will not climb the pool walls.	<ul style="list-style-type: none">• Confirm the wheel RPM is between 40 and 45. See page 10.• Empty the debris trap. Rinse the mesh panels. See page 11.• Clean the in-line screen at the universal wall fitting/quick disconnect. See page 3.• Check the tyres for excessive wear, replace as needed. See page 16.• Check the supply hose for coiling. See page 5.
Zodiac MARS™ HP supply hose coils in pool.	<ul style="list-style-type: none">• Remove the supply hose from the pool and lay in the sun in a straight line for a few hours.• Confirm that the wheel RPM is between 40 and 45 and check the in-line screen.• Empty the debris trap. See page 11.• Confirm that the supply hose length is correct for your pool. See page 4.
Zodiac MARS™ HP periodically floats to the surface.	<ul style="list-style-type: none">• Repair pool filtration/booster system problem that causes air to enter the pressure lines.

SECTION 7 – ZODIAC MARS™ HP PARTS DIAGRAM

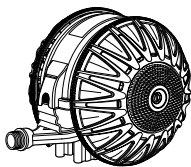
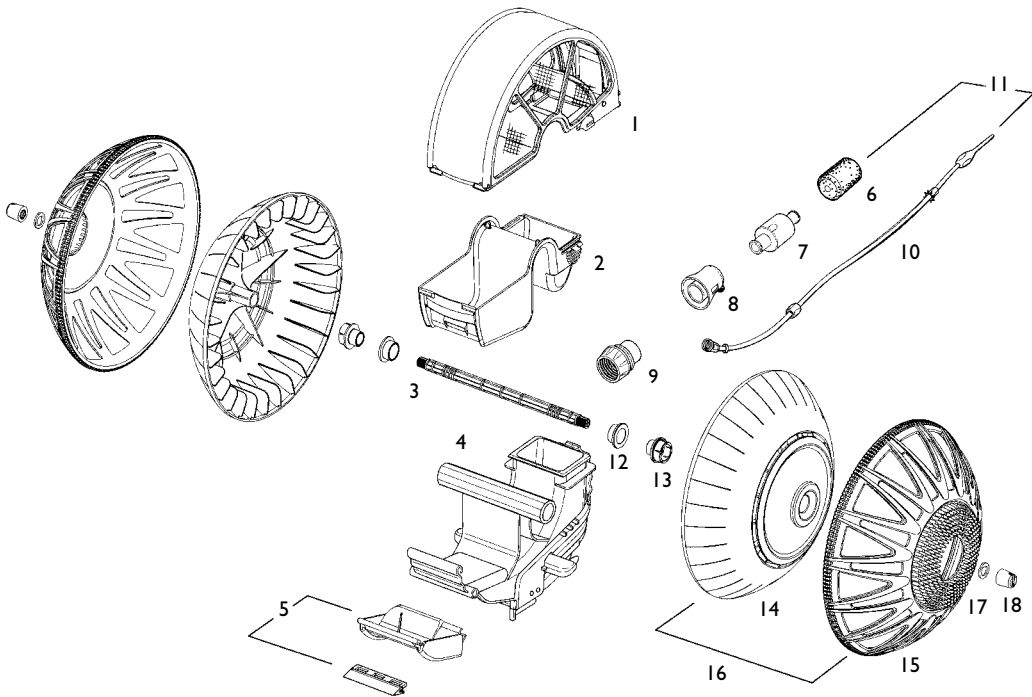

Mars HP Head

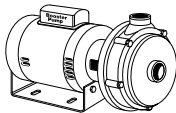

Booster Pump
(purchased separately)

DESCRIPTION

- | | |
|--|--|
| <ol style="list-style-type: none"> 1. Mars HP Debris Trap – Top 2. Mars HP Debris Trap – Bottom 3. Mars HP Axle 4. Mars HP Venturi Housing Assembly 5. Mars HP Debris Door with Wear Strap 6. Mars HP Scrubber 7. Mars HP Hose Swivel 8. Mars HP Inlet Handle – Female | <ol style="list-style-type: none"> 9. Mars HP Inlet Handle – Male 10. Mars HP Power Sweep 11. Mars HP Power Sweep with Scrubber 12. Mars HP Axle Bushing x2 13. Mars HP Wheel Bushing x2 14. Mars HP Wheel x2 15. Mars HP Tyre x2 16. Mars HP Wheel Assembly x2 17. Mars HP Washer x2 18. Mars HP Nut x2 |
|--|--|

STOP: If listed parts are missing, please contact your pool builder/retailer immediately.

Mars Supply Hose (19)

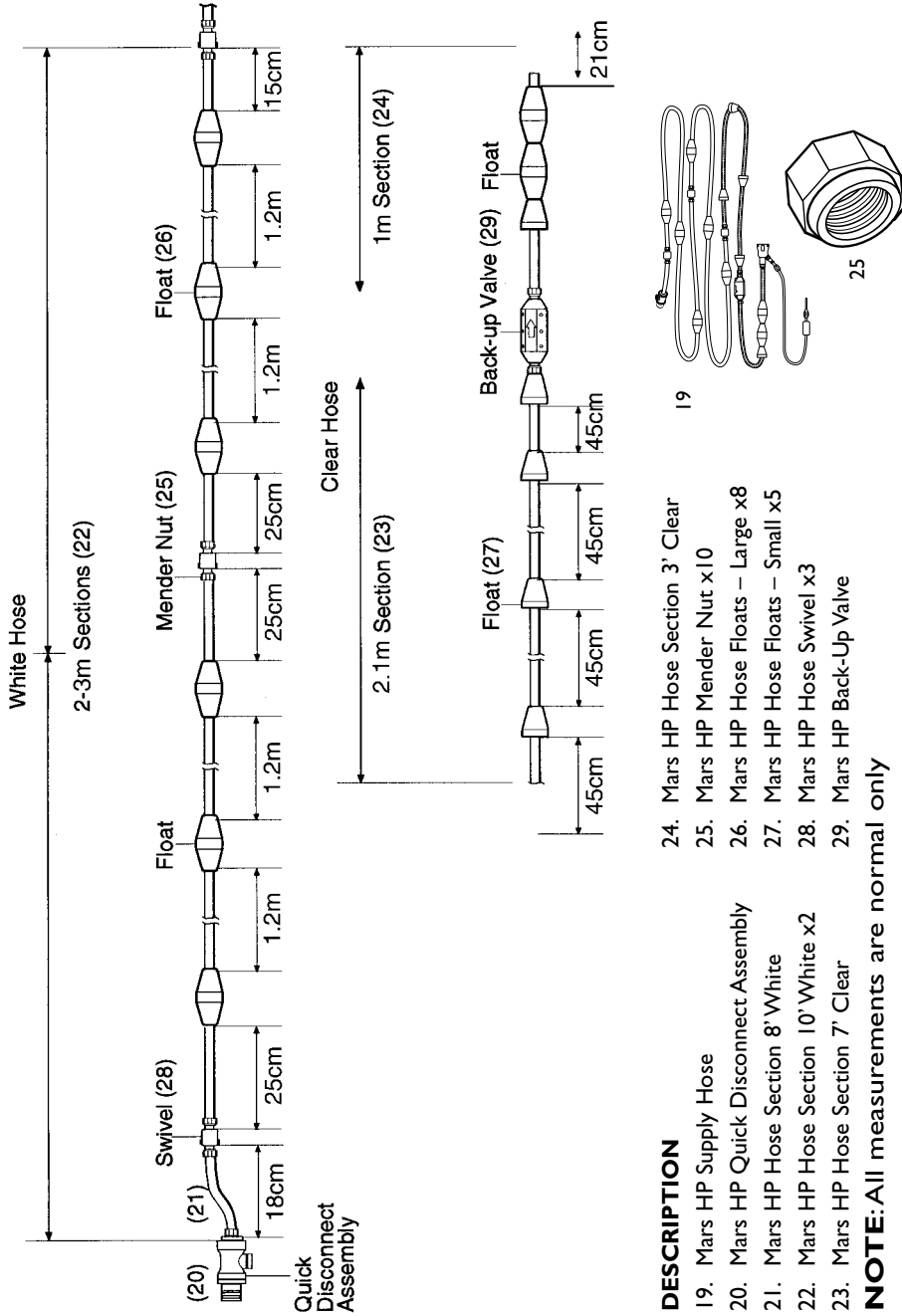

DESCRIPTION

- 19. Mars HP Supply Hose
- 20. Mars HP Quick Disconnect Assembly
- 21. Mars HP Hose Section 8' White
- 22. Mars HP Hose Section 10' White x2
- 23. Mars HP Hose Section 7' Clear
- 24. Mars HP Hose Section 3' Clear
- 25. Mars HP Mender Nut x10
- 26. Mars HP Hose Floats – Large x8
- 27. Mars HP Hose Floats – Small x5
- 28. Mars HP Hose Swivel x3
- 29. Mars HP Back-Up Valve

NOTE:All measurements are normal only

STOP: If listed parts are missing, please contact your pool builder/retailer immediately.

WARRANTY INFORMATION

ZODIAC MARS™ HP TWO-YEAR WARRANTY

This ZODIAC MARS™ HP was carefully inspected before shipment from our warehouse. Upon unpacking, if any part is missing or found to be defective, please notify your dealer immediately. Please consult owner's manual for complete instructions on the installation and operation of your ZODIAC MARS™ HP.

ZODIAC GROUP AUSTRALIA WARRANTS THE ZODIAC MARS™ HP POOL CLEANER TO BE FREE FROM DEFECTS IN MATERIALS AND WORKMANSHIP FOR A PERIOD OF TWO (2) YEARS FROM DATE OF PURCHASE. THE ZODIAC MARS™ HP HOSE IS WARRANTED FOR TWO (2) YEARS AGAINST MANUFACTURING DEFECTS AND ULTRAVIOLET BREAKDOWN.

THIS LIMITED WARRANTY EXCLUDES THE FOLLOWING:

1. Discolouration of the ZODIAC MARS™ HP pool cleaner caused by reaction to chemicals used in the pool water. Discolouration does not affect the operating ability of the ZODIAC MARS™ HP. Therefore, this limited warranty does not cover the replacement of discoloured parts.
2. Damage to or malfunction of the unit resulting from excess chlorination or improper water chemistry balance.
3. Replacement of parts which fail or become defective as a result of improper installation, negligence, misuse, abuse or tampering by unauthorised repair personnel.
4. Age, pool water imbalance, and improper installation can cause pool liners to become brittle or unduly wrinkled. Corrosion of the supporting walls and/or irregularities in the pool base may also cause liner failure. The use of this product in such an environment is at the pool owner's risk. Therefore, the pool owner hereby releases the manufacturer from any and all claims for damage where these conditions exist.
5. Abrasion to the hose or damage caused by misuse or improper installation.

No claim under this limited warranty will be recognised unless the attached registration card is completed and returned within fourteen (14) days of the day of purchase. Only the original purchaser may submit a claim under this limited warranty. Purchaser's claims against Zodiac Group Australia Pty. Ltd. shall be limited to those claims which may be asserted under the limited warranty relating to any defect, malfunction or wear of the ZODIAC MARS™ HP.

To obtain warranty replacement or repair, the unit should be returned, freight prepaid, to the place of purchase or directly to: Zodiac Group Australia Pty. Ltd. Unit 1, 23 Rowood Road Prospect NSW 2148. When submitting a claim, always supply serial number, evidence of purchase date, retailer and a brief description of the problems/defects encountered. Zodiac Group Australia Pty. Ltd. reserves the right to repair or replace all defective or worn parts covered by this limited warranty and return same to purchaser, freight collect.

Zodiac Group Australia Pty. Ltd. assumes no responsibility for any warranties or representations made by other individuals or businesses beyond the express terms contained in this limited warranty.

This warranty gives you specific legal rights, and you may also have other rights which vary from state to state.

This warranty will remain the property of Zodiac Group Australia Pty. Ltd.



Baracuda® is a registered trademark of Zodiac Group Australia Pty Ltd.

ABN: 87 002 641 965
1/ 23 Rowood Road Prospect
NSW 2148 Australia
Tel: 1800 688 552 Fax: +61(0)2 9896 5766
www.zodiac.com.au
Copyright Reserved © 2003